

PROJECT MANAGER J. TIBBITTS
 CHECK A. CHIRICOSTA
 DRAFTING D. LULEY
 CHECK A. CHIRICOSTA
 DESIGN D. LULEY
 JOB MANAGER J. TIBBITTS
 DESIGN SUPERVISOR C. DODGE

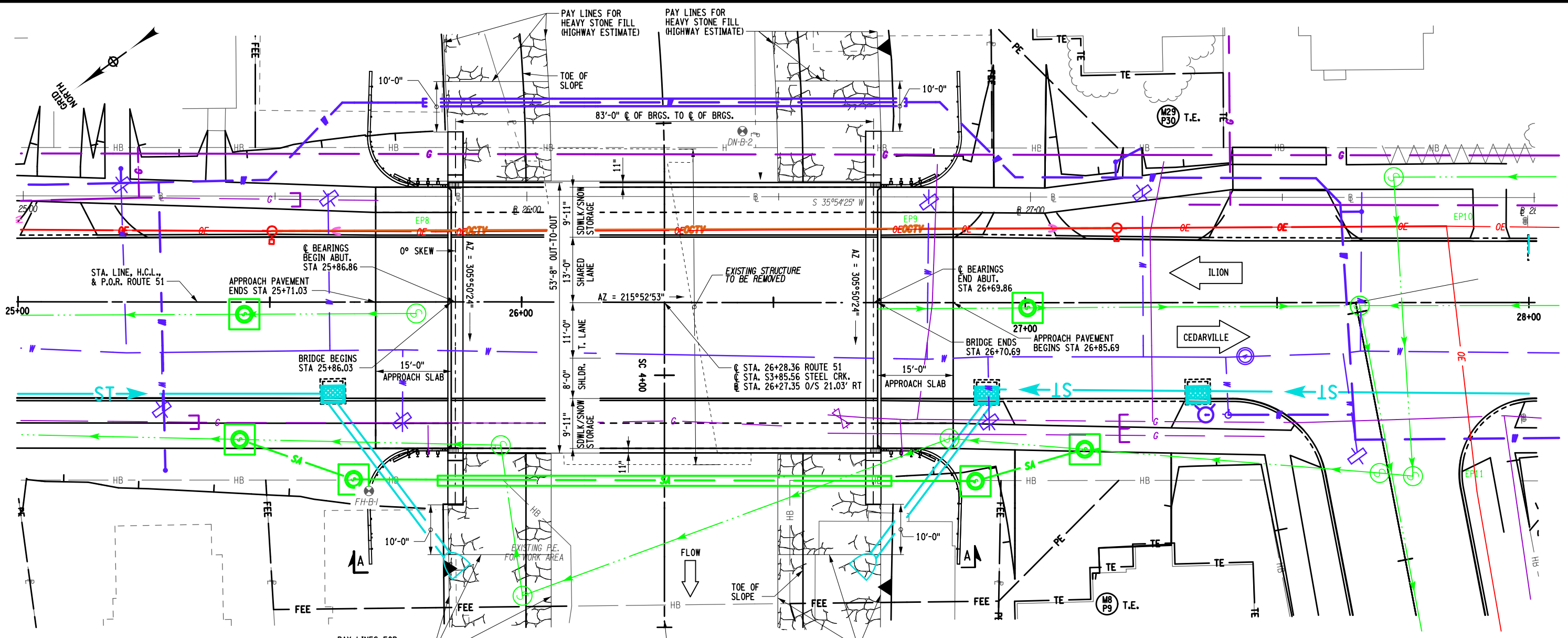

STEELE CREEK CURVE DATA	
PC STATION	P.C. = 2+41.34
RADIUS	R = 376.89
LENGTH OF CURVE	L = 120.13

HYDRAULIC DATA			
DRAINAGE AREA	27 SQ. MILES	BASIC FLOOD	DESIGN FLOOD
REQUENCY INTERVAL (YEARS)	100	50	
PEAK DISCHARGE (FT. ³ /S)	4008	3453	
HIGH WATER ELEVATION AT POINT OF MAX. BACKWATER	EXISTING 431.5	PROPOSED 430.7	431.0
AVG. VELOCITY THRU STRUCT. @ DESIGN FLOOD	8.2 FT./SEC.		
SCOUR ANALYSIS:	MINIMUM CHANNEL EL.	417.6 FT.	
	Q100 SCOUR DEPTH (FT)	Q100 SCOUR ELEV. (FT)	Q500 SCOUR DEPTH (FT)
BEGIN ABUTMENT	3.0	414.6	7.2
PIER	NA	NA	NA
END ABUTMENT	3.0	414.6	8.0
SCOUR DEPTH IS MEASURED FROM MINIMUM CHANNEL ELEVATION			

LOAD RATING (LRFR)		
INVENTORY	HL-93	1.3
OPERATING	HL-93	1.7
LOAD RATING (LFR)		
INVENTORY	HS 30	54 TONS
OPERATING	HS 50	90 TONS

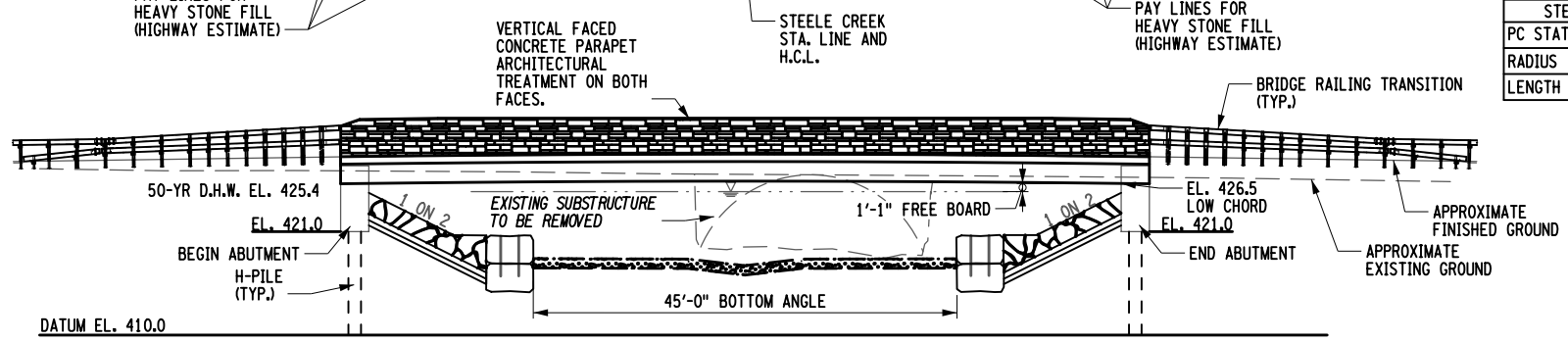

ELEVATION A-A

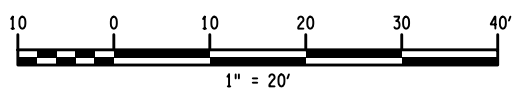

AFFIX SEAL: Daniel P. Luley
 ON: 10/21/2021
 ALTERED BY: ON:



AS-BUILT REVISIONS	ROUTE 51 OVER STEELE CREEK	PIN 2004.12	BRIDGES 1026490	CULVERTS	ALL DIMENSIONS IN FT UNLESS OTHERWISE NOTED	CONTRACT NUMBER D264647
DESCRIPTION OF ALTERATIONS:	S.H. 5513 - ILION VILLAGE-OTSEGO ST	ROUTE 51			GENERAL PLAN	DRAWING NO. ST-1
	VILLAGE OF ILION				ROUTE 51 OVER STEELE CREEK	SHEET NO. 60
	COUNTY: HERKIMER	REGION: 02				

IT IS A VIOLATION OF LAW FOR ANY PERSON, UNLESS THEY ARE ACTING UNDER THE DIRECTION OF A LICENSED PROFESSIONAL ENGINEER, ARCHITECT, LANDSCAPE ARCHITECT, OR LAND SURVEYOR, TO ALTER AN ITEM IN ANY WAY. IF AN ITEM BEARING THE STAMP OF A LICENSED PROFESSIONAL IS ALTERED, THE ALTERING ENGINEER, ARCHITECT, LANDSCAPE ARCHITECT, OR LAND SURVEYOR SHALL STAMP THE DOCUMENT AND INCLUDE THE NOTATION "ALTERED BY" FOLLOWED BY THEIR SIGNATURE, THE DATE OF SUCH ALTERATION, AND A SPECIFIC DESCRIPTION OF THE ALTERATION.



FILE NAME = 200412_cpb_gen
 DATE/TIME = 19-OCT-2021 07:35
 USER = dluley

PROJECT MANAGER: J. TIBBITTS
 CHECK: A. CHIRICOSTA
 DRAFTING: D. LULEY
 DESIGN: D. LULEY
 JOB MANAGER: J. TIBBITTS
 DESIGN SUPERVISOR: C. DODGE

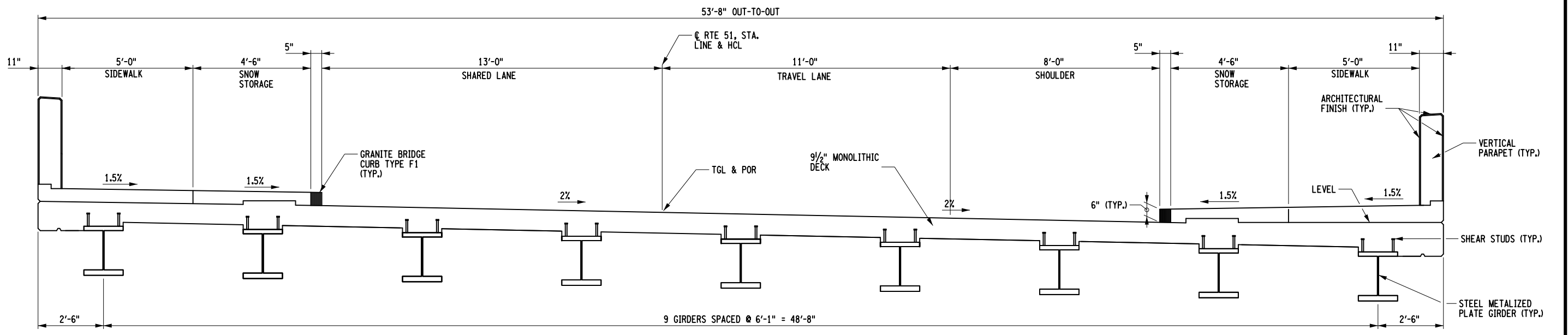
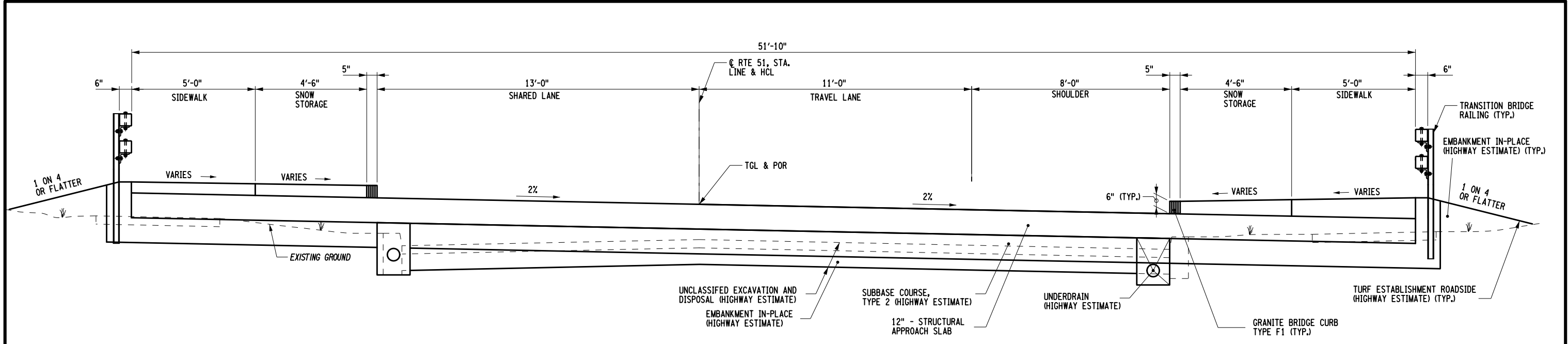

AFFIX SEAL: Daniel P. Luley
 ON: 10/21/2021
 ALTERED BY: ON:

AS-BUILT REVISIONS DESCRIPTION OF ALTERATIONS:	ROUTE 51 OVER STEELE CREEK	PIN 2004.12 ROUTE 51	BRIDGES 1026490	CULVERTS	ALL DIMENSIONS IN FT UNLESS OTHERWISE NOTED	CONTRACT NUMBER D264647
	S.H. 5513 - ILION VILLAGE-OTSEGO ST					
	VILLAGE OF ILION					
COUNTY: HERKIMER	REGION: 02	TYPICAL SECTION		DRAWING NO. ST-2		
ROUTE 51 OVER STEELE CREEK						SHEET NO. 61

IT IS A VIOLATION OF LAW FOR ANY PERSON, UNLESS THEY ARE ACTING UNDER THE DIRECTION OF A LICENSED PROFESSIONAL ENGINEER, ARCHITECT, LANDSCAPE ARCHITECT, OR LAND SURVEYOR, TO ALTER AN ITEM IN ANY WAY. IF AN ITEM BEARING THE STAMP OF A LICENSED PROFESSIONAL IS ALTERED, THE ALTERING ENGINEER, ARCHITECT, LANDSCAPE ARCHITECT, OR LAND SURVEYOR SHALL STAMP THE DOCUMENT AND INCLUDE THE NOTATION "ALTERED BY" FOLLOWED BY THEIR SIGNATURE, THE DATE OF SUCH ALTERATION, AND A SPECIFIC DESCRIPTION OF THE ALTERATION.



FILE NAME = 200412_cpb_sec.typ
 DATE/TIME = 06-OCT-2021 10:37
 USER = dluley